



ILLINOIS TOLLWAY NEWS

FOR IMMEDIATE RELEASE
October 19, 2022

**WEEKEND RAMP AND LANE CLOSURES SCHEDULED ON TRI-STATE TOLLWAY (I-294)
FOR NEW LONG-TERM TRAFFIC SHIFT BETWEEN ROBERTS ROAD AND 95th STREET**
New traffic pattern on southbound I-294 will limit access to 95th Street Interchange

DOWNERS GROVE, IL – Weekend-long lane closures, including a detour of the ramp carrying the southbound Central Tri-State Tollway (I-294) to westbound 95th Street, are scheduled for work to shift traffic on southbound I-294 between 87th Street/Roberts Road and 95th Street.

Once the new traffic pattern is in place, southbound I-294 traffic will be in a counterflow lane configuration with limited access to exit at 95th Street. Traffic will remain in this configuration through the end of the year.

Closures are necessary to shift traffic and provide a safe work zone for median reconstruction and accommodate traffic during construction. Electronic message signs and construction signage will be put in place in advance to alert drivers to the closures, detour and new traffic patterns. Up-to-date information regarding lane closures will be available in the Illinois Tollway's [Daily Construction Alert](#). All work is weather dependent.

Beginning Friday, October 21, at 8 p.m. and continuing through 6 a.m. Monday, October 24, the ramp connecting southbound I-294 to westbound 95th Street is scheduled to close with a posted detour. The detour will direct southbound I-294 traffic to eastbound 95th Street/76th Avenue and onto northbound 76th Avenue where traffic will be able to access 95th Street in either direction. See map below.

In addition, on southbound I-294 between 87th Street/Roberts Road and 95th Street, a weekend-long single lane closure will be put in place, with nightly closure of up to three lanes as needed to complete the traffic shift. All lanes are scheduled to reopen by 6 a.m. on Monday, October 24.

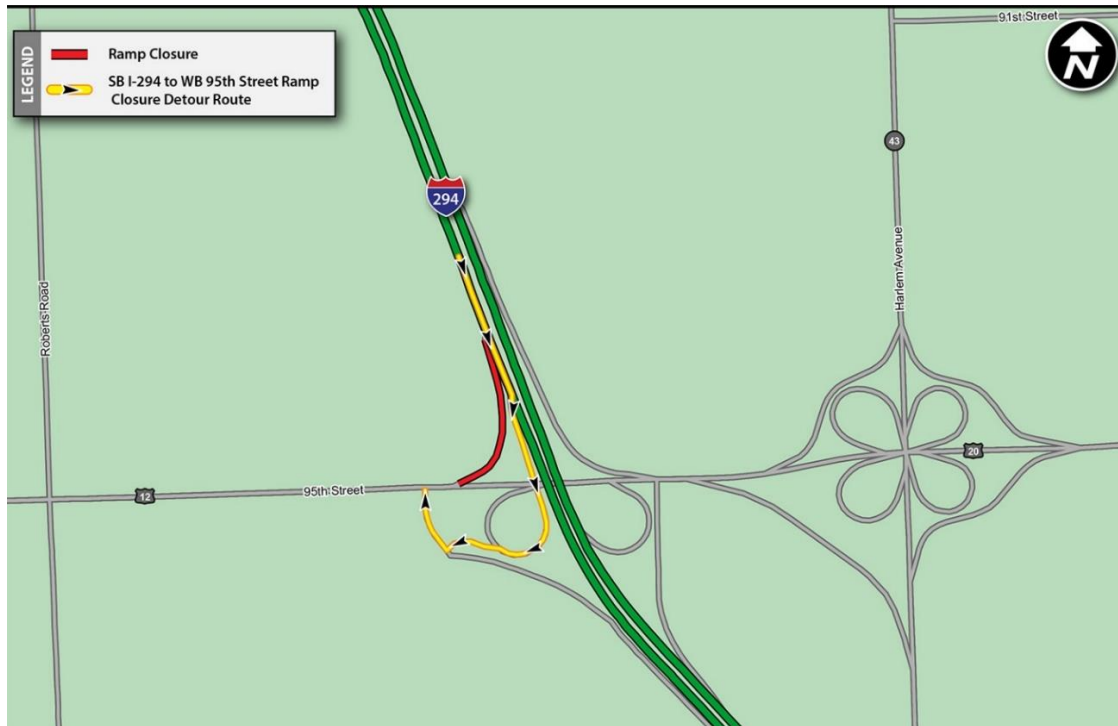

Once the weekend work is complete, one lane of southbound I-294 traffic will be shifted onto newly reconstructed southbound pavement, with three lanes of southbound traffic remaining on the northbound side of the roadway in a counterflow configuration to provide a work zone between the southbound lanes. Traffic traveling in the three counterflow lanes will not have access to the 95th Street Interchange. Northbound traffic in this area is currently shifted and will remain in the same configuration. Traffic shift diagrams are available [on the Project page](#) on the Tollway's website.

Traffic in both directions between 87th Street/Roberts Road and 95th Street will remain in this configuration through the end of the year with work continuing to rebuild the southbound I-294 bridge over 87th Street. Work also includes mainline roadway construction and noisewall, median, storm sewer and utility work.

Traffic shift diagrams are available [on the Project page](#) on the Tollway's website.

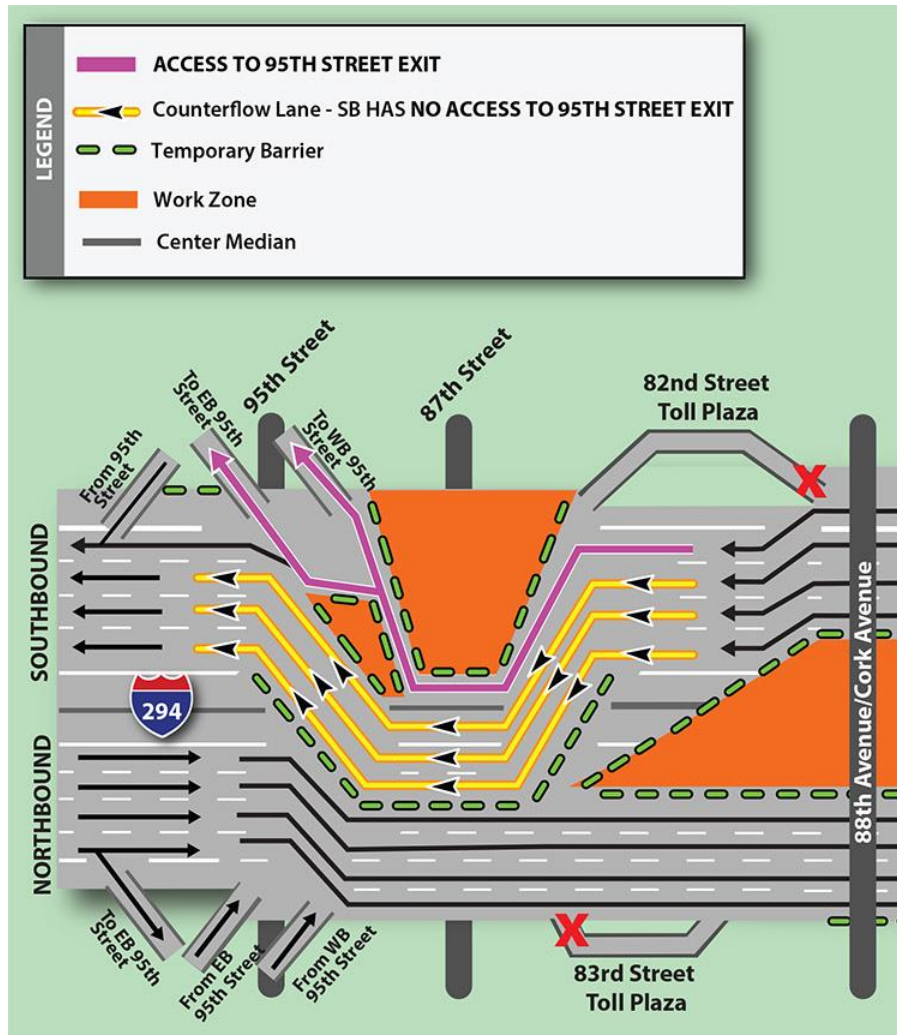

Work in this area is being coordinated with the Illinois Department of Transportation, Cook County Department of Transportation and Highways, Village of Burr Ridge, City of Countryside, City of Hickory Hills, Village of Hodgkins, Village of Indian Head, Village of Justice, as well as local fire and police departments.

Construction updates, project information, maps and detour information for work that is part of the Central Tri-State Tollway (I-294) Project is available in the Projects section on the Tollway's website at www.illinoistollway.com.

Work in this southern section of the Central Tri-State Project between I-55 and 95th Street began in 2019 and mainline reconstruction and widening is scheduled to be complete by the end of 2023. Mainline improvements include rebuilding and widening the I-294 roadway to five lanes in both directions, including construction of new I-294 bridges over I-55, Flagg Creek, 87th Street and Roberts Road, as well as reconstructing shoulders including adding Flex Lanes. Improvements also include reconstruction of the Mile Long Bridge, the Archer Avenue Interchange, the ramp connecting I-55 to northbound I-294 and local crossroad bridges, including Willow Springs Road and 5th Avenue.

The \$4 billion Central Tri-State Tollway (I-294) Project is reconstructing and widening the roadway between Balmoral Avenue and 95th Street to provide congestion relief, update old infrastructure to meet current and future transportation demand and address regional needs. This work is part of the Tollway's

15-year, \$14 billion capital program, *Move Illinois: The Illinois Tollway Driving the Future*. More than 220,000 vehicles use the Central Tri-State Tollway daily.

Work Zone Safety

Construction zone speed limits are in effect in all construction zones 24/7 and drivers should continue to watch for changing traffic patterns and use caution, especially when workers are present. On I-294, a 45 mph work zone speed limit is in effect throughout the construction season.

The Illinois Tollway reminds motorists that the “Move Over Law” requires motorists to change lanes or to slow down and proceed with caution when passing any vehicle on the side of the road with hazard lights activated. If you see flashing lights ahead, please move over or slow down.

Illinois State Police have zero tolerance for drivers speeding in work zones or failure to comply with the Move Over Law. The minimum penalty for speeding in a work zone is \$250 with up to a \$25,000 fine and a 14-year jail sentence for hitting a roadway worker. Penalties for failure to slow down or move over for a vehicle on the shoulder with flashing lights includes up to a \$10,000 fine, 2-year suspension of driving privileges and jail time, in extreme cases.

About Move Illinois

The Illinois Tollway’s 15-year, \$14 billion capital program, *Move Illinois: The Illinois Tollway Driving the Future*, is improving mobility, relieving congestion, reducing pollution, creating as many as 152,000 jobs and linking economies throughout the region. The first 10 years of *Move Illinois* are on schedule and within budget, delivering the rebuilt and widened Jane Addams Memorial Tollway (I-90) as a state-of-the-art 21st century corridor and opening a new interchange connecting the Tri-State Tollway (I-294) to I-57. Progress continues on projects addressing the remaining needs of the existing Tollway system, delivering the Elgin O’Hare Western Access Project and reconstructing the Central Tri-State Tollway (I-294).

About the Illinois Tollway

The Illinois Tollway is a user-fee system that receives no state or federal funds for maintenance and operations. The agency maintains and operates 294 miles of roadways in 12 counties in Northern Illinois, including the Reagan Memorial Tollway (I-88), the Veterans Memorial Tollway (I-355), the Jane Addams Memorial Tollway (I-90), the Tri-State Tollway (I-94/I-294/I-80) and the Illinois Route 390 Tollway.

###