



ILLINOIS TOLLWAY NEWS

FOR IMMEDIATE RELEASE
February 2, 2023

OVERNIGHT CLOSURES WITH RAMP DETOURS SCHEDULED TO PREPARE FOR TRAFFIC SHIFT ON CENTAL TRI-STATE TOLLWAY (I-294)

New traffic pattern between the Cermak Road Toll Plaza and St. Charles Road will accommodate ongoing winter construction as weather permits

DOWNERS GROVE, IL – Overnight lane closures will be scheduled as weather allows beginning this weekend on the northern segment of the Central Tri-State Tollway (I-294) near the Village of Berkley and will include detours for the ramps connecting northbound I-294 and the eastbound Reagan Memorial Tollway (I-88) to westbound I-290 and westbound I-290 to northbound I-294.

The closures are needed to shift traffic on northbound I-294 between the Cermak Road Toll Plaza and St. Charles Road to accommodate ongoing construction during the winter. The new traffic pattern will maintain four lanes of northbound I-294 with traffic shifted into a split configuration to allow for a workzone in the middle. Traffic will remain in this split configuration until 2024.

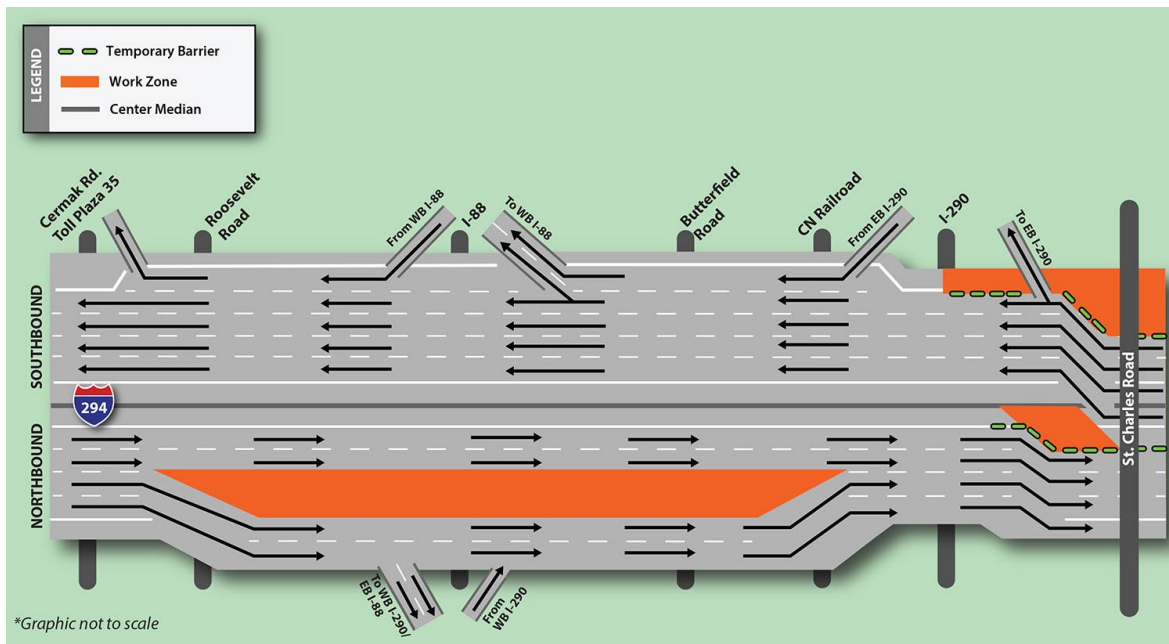

Beginning on Saturday, February 4, daytime single lane closures are scheduled to begin on northbound I-294 between Cermak Road Toll Plaza and St. Charles Road. In addition, daytime closures are scheduled on the ramps carrying eastbound I-88 to both northbound I-294 and to westbound I-290 and detours will be posted (see detour maps below for details).

On Sunday, February 5, similar daytime lane closures will be scheduled on northbound I-294 with traffic shifts on the ramps carrying northbound I-294 traffic to I-290 in both directions.

In addition, the ramps carrying eastbound I-88 to northbound I-294 and to westbound I-290 are also scheduled to close overnight during this time [for ongoing bridge beam placement work](#).

Overnight lane and ramp closures are scheduled to continue during the week of February 6 with traffic on northbound I-294 reduced to a single lane at times. Ramp closures and detours will be scheduled between midnight and 5 a.m. for the following ramps:

- Northbound I-294 and eastbound I-88 to westbound I-290: Traffic will be routed to Mannheim Road and through the interchange onto westbound I-290.
- Eastbound I-88 to northbound I-294: Traffic will be routed to Mannheim Road and through the interchange onto northbound I-294.
- Westbound I-290 to northbound I-294: Traffic will be routed on westbound I-290 to east Lake Street to northbound I-294.



[View NB I-294 and EB I-88 to WB I-290 Detour Map](#)



[View EB I-88 to NB I-294 Detour Map](#)



[View WB I-290 to NB I-294 Detour Map](#)

Construction and electronic message signs will be in place in advance to alert drivers to the overnight lane closures and detour. Up-to-date closure information will be available on the Illinois Tollway's [Daily Construction Alert](#). All work is weather dependent.

Construction in this area is being coordinated with the Illinois Department of Transportation, Village of Berkeley, City of Elmhurst, Village of Hillside, Village of Northlake, Village of Oak Brook and Proviso Township, as well as local fire and police departments.

Information including maps and construction updates is available on the Tollway's website at www.illinoistollway.com in the Projects section.

The \$4 billion Central Tri-State Tollway (I-294) Project is reconstructing and widening the roadway between Balmoral Avenue and 95th Street to provide congestion relief, update old infrastructure to meet current and future transportation demand and address regional needs. This work is part of the Tollway's 15-year, \$14 billion capital program, *Move Illinois: The Illinois Tollway Driving the Future*. More than 220,000 vehicles use the Central Tri-State Tollway daily.

Work Zone Safety

Construction zone speed limits are in effect in all construction zones 24/7 and drivers should continue to watch for changing traffic patterns and use caution, especially when workers are present.

The Illinois Tollway reminds motorists that the "Move Over Law" requires motorists to change lanes or to slow down and proceed with caution when passing any vehicle on the side of the road with hazard lights activated. If you see flashing lights ahead, please move over or slow down.

Illinois State Police have zero tolerance for drivers speeding in work zones or failure to comply with the Move Over Law. The minimum penalty for speeding in a work zone is \$250 with up to a \$25,000 fine and a 14-year jail sentence for hitting a roadway worker. Penalties for failure to slow down or move over for a vehicle on the shoulder with flashing lights includes up to a \$10,000 fine, 2-year suspension of driving privileges and jail time, in extreme cases.

About Move Illinois

The Illinois Tollway's 15-year, \$14 billion capital program, *Move Illinois: The Illinois Tollway Driving the Future*, is improving mobility, relieving congestion, reducing pollution, creating as many as 152,000 jobs and linking economies throughout the region. The first 11 years of *Move Illinois* are on schedule and within budget, delivering the rebuilt and widened Jane Addams Memorial Tollway (I-90) as a state-of-the-art 21st century corridor and opening a new interchange connecting the Tri-State Tollway (I-294) to I-57. Progress continues on projects addressing the remaining needs of the existing Tollway system, delivering the Elgin O'Hare Western Access Project and reconstruction of the Central Tri-State Tollway (I-294).

About the Illinois Tollway

The Illinois Tollway is a user-fee system that receives no state or federal funds for maintenance and operations. The agency maintains and operates 294 miles of roadways in 12 counties in Northern Illinois, including the Reagan Memorial Tollway (I-88), the Veterans Memorial Tollway (I-355), the Jane Addams Memorial Tollway (I-90), the Tri-State Tollway (I-94/I-294/I-80) and the Illinois Route 390 Tollway.

###