



ILLINOIS TOLLWAY NEWS

FOR IMMEDIATE RELEASE
March 14, 2024

LONG-TERM TRAFFIC SHIFTS SCHEDULED TO BEGIN NEXT WEEK ON CENTRAL SECTION OF CENTRAL TRI-STATE (I-294) PROJECT

New traffic pattern southbound between Cermak Road and I-55 will accommodate ongoing construction in 2024

DOWNERS GROVE, IL – Overnight lane closures will be scheduled next week on the Central Tri-State Tollway (I-294) Project to begin shifting southbound traffic between Cermak Road and I-55 into a work zone configuration for the 2024 construction season.

Construction and electronic message signs will be in place in advance to alert drivers to the overnight lane closures and traffic shift. Up-to-date closure information will be available on the Illinois Tollway's [Daily Construction Alert](#). All work is weather dependent.

Beginning overnight Monday, March 19, two nights of lane closures will be scheduled between 8 p.m. and 5 a.m. on southbound I-294 between the Hinsdale Oasis and I-55 to prepare to shift traffic to the left.

At times, traffic will be reduced to a single lane while work is underway to prepare for the traffic shift. When complete, traffic will be shifted into a new configuration to provide for a construction work zone on the right side of southbound I-294.

Later this spring, overnight lane closures on southbound I-294 will also be scheduled between Cermak Road and the Hinsdale Oasis to shift traffic to the left. Once this work is complete, all traffic on southbound I-294 between Cermak Road and I-55 will be shifted to the left with a work zone on the right.

Traffic is scheduled to remain in this configuration through summer 2024, with additional off peak and overnight closures scheduled as needed.

Traffic on northbound I-294 between I-55 and Cermak Road will remain in its current configuration.

In 2024, work in this area includes construction of southbound mainline pavement, shoulder work, reconstruction of the I-294 bridge over Salt Creek, noisewall construction and storm sewer and utility work.

Construction in this area is being coordinated with the Illinois Department of Transportation, Cook County Department of Transportation and Highways, Village of Western Springs, Village of Indian Head Park, Village of Hinsdale, Village of Oak Brook, Provisio Township, Village of Burr Ridge as well as local fire and police departments.

Mainline construction between St. Charles Road and I-55 is currently scheduled through 2026. The Tollway will rebuild the roadway with widening of up to six lanes in both directions in some areas, deliver new SmartRoad infrastructure, as well as deliver reconstructed shoulders and addition of Flex Lanes.

-more-

Information, including maps and construction updates, is available on the Tollway's website at www.illinoistollway.com in the Projects section.

As part of the \$4 billion Central Tri-State Tollway (I-294) Project, the Tollway is reconstructing and widening the roadway between Balmoral Avenue and 95th Street to provide congestion relief, update old infrastructure to meet current and future transportation demand and address regional needs. This work is part of the Tollway's *Move Illinois* Program. More than 220,000 vehicles use the Central Tri-State Tollway daily.

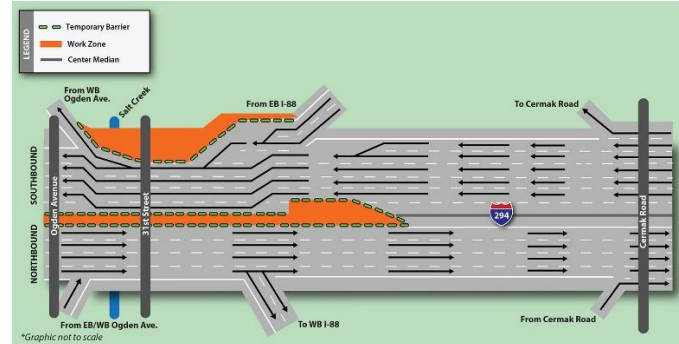
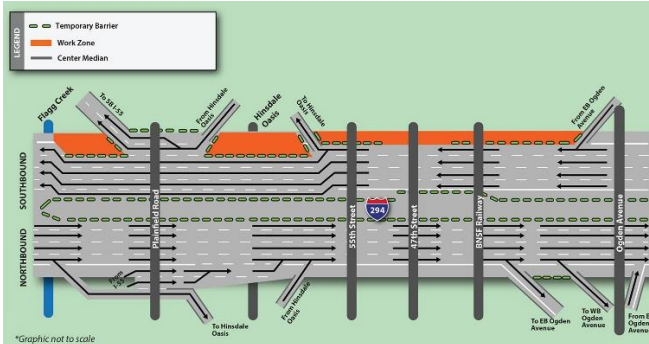

Work Zone Safety

Construction zone speed limits are in effect in all construction zones 24/7 and drivers should continue to watch for changing traffic patterns and use caution, especially when workers are present. On Butterfield Road, a 35 mph work zone speed limit is in effect. On I-294, a 45 mph work zone speed limit is in effect throughout the construction season.

The Illinois Tollway reminds motorists that the "Move Over Law" requires motorists to change lanes or to slow down and proceed with caution when passing any vehicle on the side of the road with hazard lights activated. If you see flashing lights ahead, please move over or slow down.

Illinois State Police have zero tolerance for drivers speeding in work zones or failure to comply with the Move Over Law. The minimum penalty for speeding in a work zone is \$250 with up to a \$25,000 fine and a 14-year jail sentence for hitting a roadway worker. Penalties for failure to slow down or move over for a vehicle on the shoulder with flashing lights includes up to a \$10,000 fine, 2-year suspension of driving privileges and jail time, in extreme cases.

About Move Illinois

The Illinois Tollway's 16-year, \$15 billion capital program, *Move Illinois: The Illinois Tollway Driving the Future*, is improving mobility, relieving congestion, reducing pollution, creating as many as 165,220 jobs and linking economies throughout the region. The first 12 years of *Move Illinois* are on schedule and within budget, delivering the new Illinois Route 390 Tollway and a rebuilt and widened Jane Addams Memorial Tollway (I-90) with its new SmartRoad corridor, as well as opening a new interchange connecting the Tri-State Tollway (I-294) to I-57. Progress continues on projects addressing the remaining needs of the existing Tollway system, delivering the new I-490 Tollway Project and reconstruction of the Central Tri-State Tollway (I-294).

About the Illinois Tollway

The Illinois Tollway is a user-fee system that receives no state or federal funds for maintenance and operations. The agency maintains and operates 294 miles of roadways in 12 counties in Northern Illinois, including the Reagan Memorial Tollway (I-88), the Veterans Memorial Tollway (I-355), the Jane Addams Memorial Tollway (I-90), the Tri-State Tollway (I-94/I-294/I-80) and the Illinois Route 390 Tollway.

#