



Move Illinois:  
*The Illinois Tollway Driving the Future*

# NEWS

**FOR IMMEDIATE RELEASE**

**March 28, 2018**

**RESCHEDULED LONG-TERM TRAFFIC SHIFT TO BEGIN NEXT WEEK IN OAK BROOK  
FOR REAGAN MEMORIAL TOLLWAY (I-88) RECONSTRUCTION PROJECT**

*Westbound roadway reconstruction scheduled in 2018 between I-290 and York Road*

**DOWNERS GROVE, IL** – The Illinois Tollway is scheduled to begin work next week to start the rebuilding and widening of the westbound side of the Reagan Memorial Tollway (I-88) between I-290 and York Road in Oak Brook.

Electronic message signs and construction signage will be put in place to alert drivers in advance of work that will have an impact on traffic in both directions on I-88. More than 130,000 vehicles use this stretch of I-88 daily.

Beginning Monday, April 2, overnight lane closures are scheduled to remove rumble strips and pavement markings as well as install construction barrier wall to prepare for the new work zone.

On Wednesday, April 4, all eastbound traffic is scheduled to shift overnight to the right. Once that work is complete, in late April all westbound traffic will be shifted to the left, with one lane of traffic traveling on the eastbound side of I-88 to accommodate a work zone and at least two lanes of traffic in both directions.

In addition, traffic on the ramp connecting the southbound Tri-State Tollway (I-294) to westbound I-88 will be shifted onto temporary pavement to allow for reconstruction and realignment of the ramp to meet up with the new roadway and shoulder.

During construction, westbound traffic traveling in the lane on the eastbound side of I-88 will be shifted back onto the westbound side of the roadway after the York Road Toll Plaza, so drivers exiting at the 22<sup>nd</sup> Street ramp and cash-paying customers must travel in the right lane on the westbound side of I-88 in order to access the cash side of the toll plaza as well as the 22<sup>nd</sup> Street exit ramp. I-PASS customers will be able to pay their tolls electronically in either lane. There is no toll collection at this toll plaza for eastbound traffic.

All work is weather dependent, and traffic is scheduled to remain in this configuration through late summer.

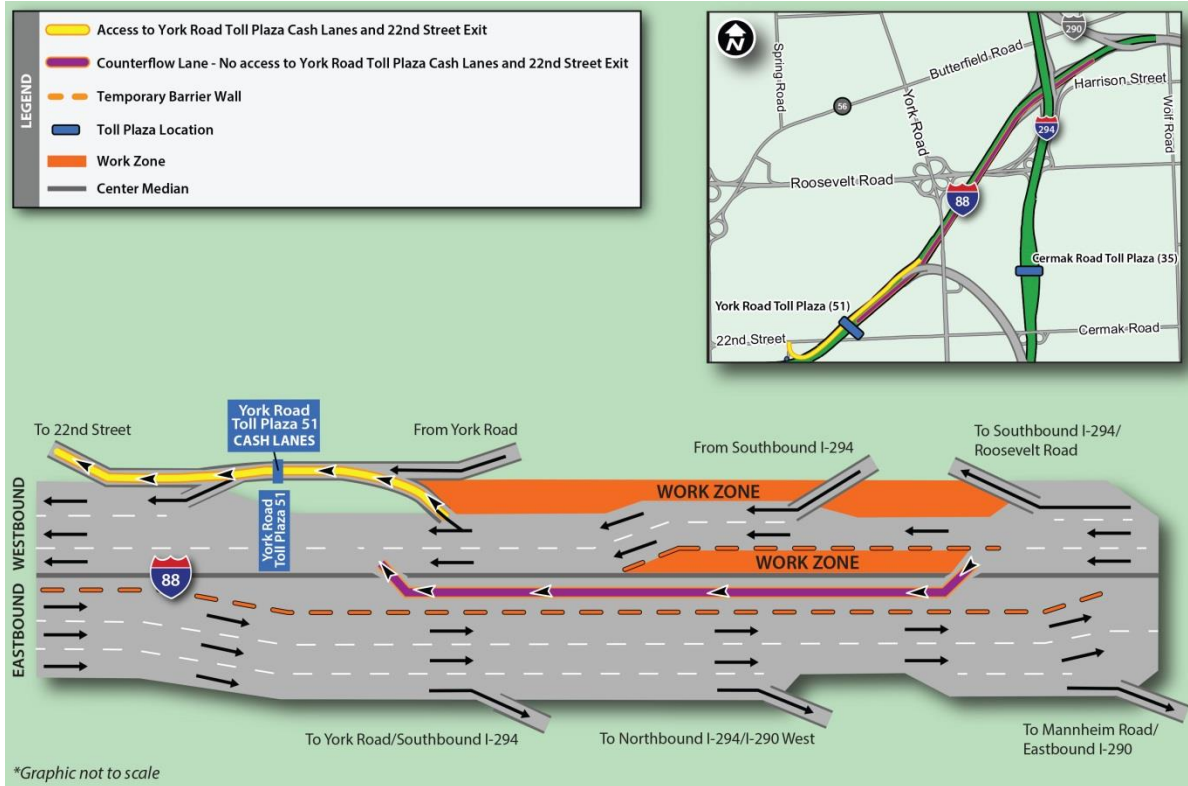

In late summer, a new traffic configuration will be put in place to complete reconstruction of the westbound lanes on I-88. At that time, the westbound lanes will shift to the right onto newly construction pavement. Eastbound traffic and the westbound lane traveling on the eastbound side will remain in the same configuration. Traffic is scheduled to remain in this configuration into winter. Reconstruction of the eastbound side of I-88 is scheduled for 2019.

The Illinois Tollway is committed to ensuring that I-88 remains safe for both drivers and workers during construction, which is part of the agency’s overall commitment to roadway safety. A 45 mph work zone speed limit will be in effect in areas with construction on I-88.

Maps and construction information about the I-88 Reconstruction Project is available on the Tollway’s website at [illinoistollway.com](http://illinoistollway.com) via the Interactive Tollway Map and under “Projects Overview” in the Explore Projects section.

The I-88 Reconstruction Project will extend the life of the roadway, increase traffic capacity and provide safe and convenient travel for Tollway customers. In addition, to rebuilding and widening I-88, the two-year project also includes rebuilding and widening the York Road Bridge, repair and widening of the I-88 bridges over Roosevelt Road, improvements on the ramps connecting I-88 and I-294 and noisewall construction adjacent to residential areas.

The project is being coordinated with the Illinois Department of Transportation, the Village of Oak Brook, the City of Elmhurst, Village of Hillside, York Township and DuPage County, as well as local fire and police departments. The project is funded by the Tollway’s *Move Illinois* Program.

**About Move Illinois**

The Illinois Tollway’s 15-year, \$14 billion capital program, *Move Illinois: The Illinois Tollway Driving the Future*, is improving mobility, relieving congestion, reducing pollution, creating as many as 120,000 jobs and linking economies throughout the region. The first five years of *Move Illinois* is on schedule and

within budget, delivering the rebuilt and widened Jane Addams Memorial Tollway (I-90) as a state-of-the-art 21<sup>st</sup> century corridor and opening a new interchange connecting the Tri-State Tollway (I-294) to I-57. Progress continues on projects addressing the remaining needs of the existing Tollway system, delivering the Elgin O'Hare Western Access Project and planning for emerging projects, including reconstruction of the Central Tri-State Tollway (I-294).

**About the Illinois Tollway**

The Illinois Tollway is a user-fee system that receives no state or federal funds for maintenance and operations. The agency maintains and operates 294 miles of roadways in 12 counties in Northern Illinois, including the Reagan Memorial Tollway (I-88), the Veterans Memorial Tollway (I-355), the Jane Addams Memorial Tollway (I-90), the Tri-State Tollway (I-94/I-294/I-80) and the Illinois Route 390 Tollway.

# # #