



# ILLINOIS TOLLWAY NEWS

**FOR IMMEDIATE RELEASE**  
**September 4, 2019**

## **WEEKEND-LONG RAMP CLOSURES SCHEDULED FOR REPAIR WORK ON REAGAN MEMORIAL TOLLWAY (I-88) AT ORCHARD ROAD** *Closures needed for repair and resurfacing work, detours will be posted*

**DOWNERS GROVE, IL** – Extended weekend ramp closures with detours are scheduled this month for pavement repair and resurfacing work on ramps at the Orchard Road Interchange on the Reagan Memorial Tollway (I-88).

Electronic message signs and construction signage will be put in place in advance to alert drivers to the ramp closures and detours. The closures are necessary to safely provide a work zone for resurfacing on the ramp. All work is weather dependent.

“The Illinois Tollway prioritizes the safety of both drivers and workers when planning for roadway maintenance and repairs,” said Illinois Tollway Executive Director José Alvarez. “While roadwork detours are inconvenient for drivers, the closures are necessary to provide a safe work zone for construction workers and completion of the repair work.”

On Friday, September 6, at 9 p.m. the ramp connecting eastbound I-88 to Orchard Road is scheduled to close to traffic through 5 a.m. on Monday, September 9. A detour will be put in place directing eastbound traffic to exit in advance of Orchard Road at Illinois Route 47 and then use U.S. Route 30 to reach Orchard Road. The next interchange east of Orchard Road is Illinois Route 31.

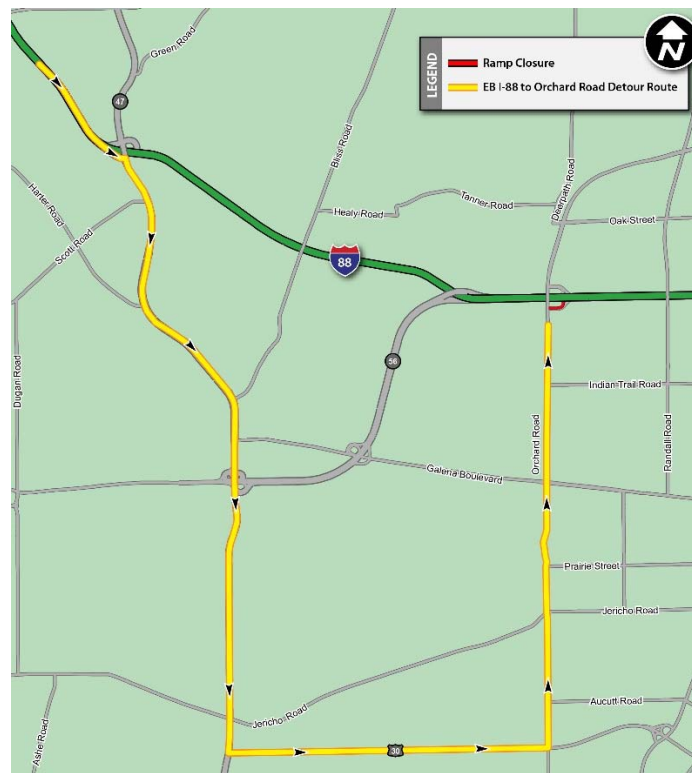

-more-

On Friday, September 13, at 9 p.m. the ramp connecting Orchard Road to westbound I-88 is scheduled to close to traffic through 5 a.m. on Monday, September 16. A detour will be put in place directing traffic to continue south on Orchard Road and then use U.S. Route 30 and Illinois Route 47 to access westbound I-88.

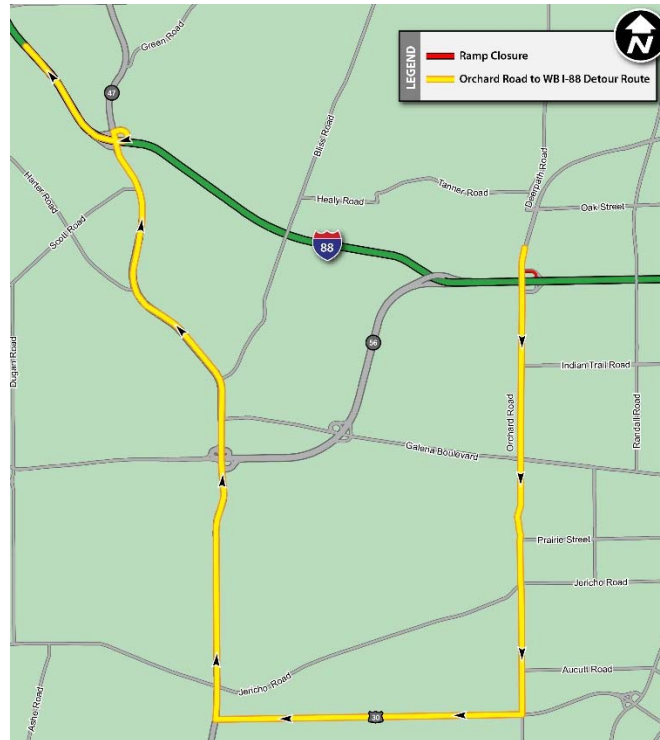

Construction and detours are being coordinated with Kane County, City of Aurora and the Village North Aurora as well as local fire and police departments.

Repair work on both Orchard Road Interchange ramps includes pavement patching and shoulder resurfacing.

The improvements on the Orchard Road Interchange on I-88 will extend the life of the interchange, improve travel in the area and provide convenient access to local communities and support economic opportunities. This work is part of the Tollway's 15-year, \$14 billion capital program, *Move Illinois: The Illinois Tollway Driving the Future*.

Maps and construction information about the I-88 Interchange Improvements is available in the Projects section on the Tollway's website at [Illinoistollway.com](http://Illinoistollway.com) and via the Interactive Tollway map.

### **Work Zone Safety**

Construction zone speed limits are in effect in all construction zones 24/7 and drivers should continue to watch for changing traffic patterns and use caution, especially when workers are present.

The Illinois Tollway reminds motorists that the "Move Over Law" requires motorists to change lanes or to slow down and proceed with caution when passing any vehicle on the side of the road with hazard lights activated. If you see flashing lights ahead, please move over or slow down.

Illinois State Police have zero tolerance for drivers speeding in work zones or failure to comply with the Move Over Law.

The minimum penalty for speeding in a work zone is \$250. Posted signs advise drivers of a \$10,000 fine and a 14-year jail sentence for hitting a roadway worker.

Penalties for failure to slow down or move over for a vehicle on the shoulder with flashing lights includes up to a \$10,000 fine, 2-year suspension of driving privileges and jail time, in extreme cases.

### **Getting Tollway Construction Information**

- The Illinois Tollway has a variety of ways customers can get the latest travel information, including: [Illinoistollway.com](http://Illinoistollway.com) – Interactive Tollway Map for construction and live roadway images.
- [Daily construction alerts](#) – Daily and long-term lane and shoulder closure schedules.
- [Twitter.com](https://twitter.com) – Real-time roadway incident information at Tollway Trip 90, Tollway Trip 88, Tollway Trip 355, Tollway Trip 94/294 and Tollway Trip 390.

### **About Move Illinois**

The Illinois Tollway's 15-year, \$14 billion capital program, *Move Illinois: The Illinois Tollway Driving the Future*, is improving mobility, relieving congestion, reducing pollution, creating as many as 120,000 jobs and linking economies throughout the region. The first seven years of *Move Illinois* are on schedule and within budget, delivering the new Illinois Route 390 Tollway and a rebuilt and widened Jane Addams Memorial Tollway (I-90) with its new SmartRoad corridor, as well as opening a new interchange connecting the Tri-State Tollway (I-294) to I-57. Progress continues on projects addressing the remaining needs of the existing Tollway system, delivering the new I-490 Tollway Project and reconstruction of the Central Tri-State Tollway (I-294) and planning for emerging projects.

### **About the Illinois Tollway**

The Illinois Tollway is a user-fee system that receives no state or federal funds for maintenance and operations. The agency maintains and operates 294 miles of roadways in 12 counties in Northern Illinois, including the Reagan Memorial Tollway (I-88), the Veterans Memorial Tollway (I-355), the Jane Addams Memorial Tollway (I-90), the Tri-State Tollway (I-94/I-294/I-80) and the Illinois Route 390 Tollway.

# # #